

INITIAL CONDITION

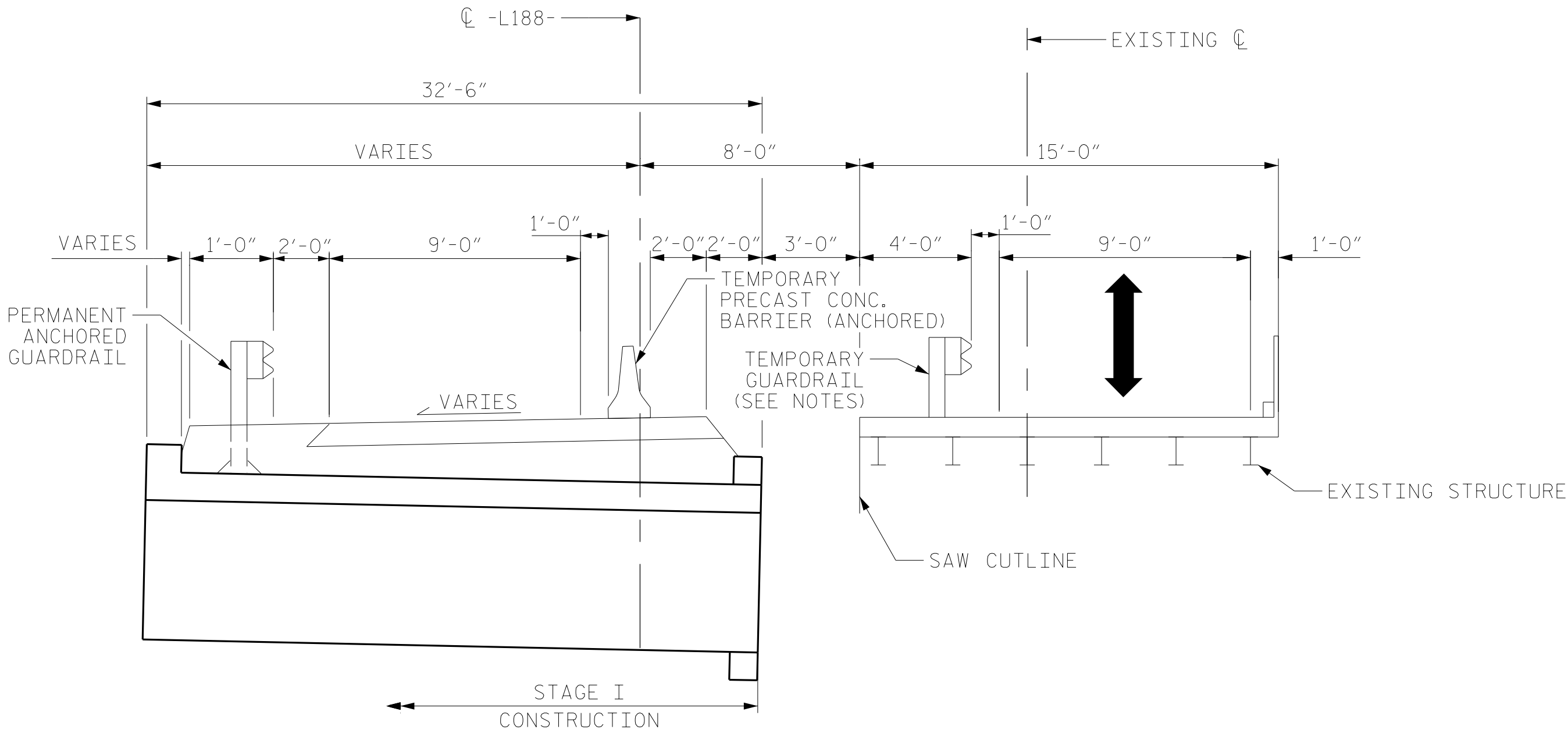

STAGE I CONSTRUCTION

NORMAL TO ROADWAY SECTION

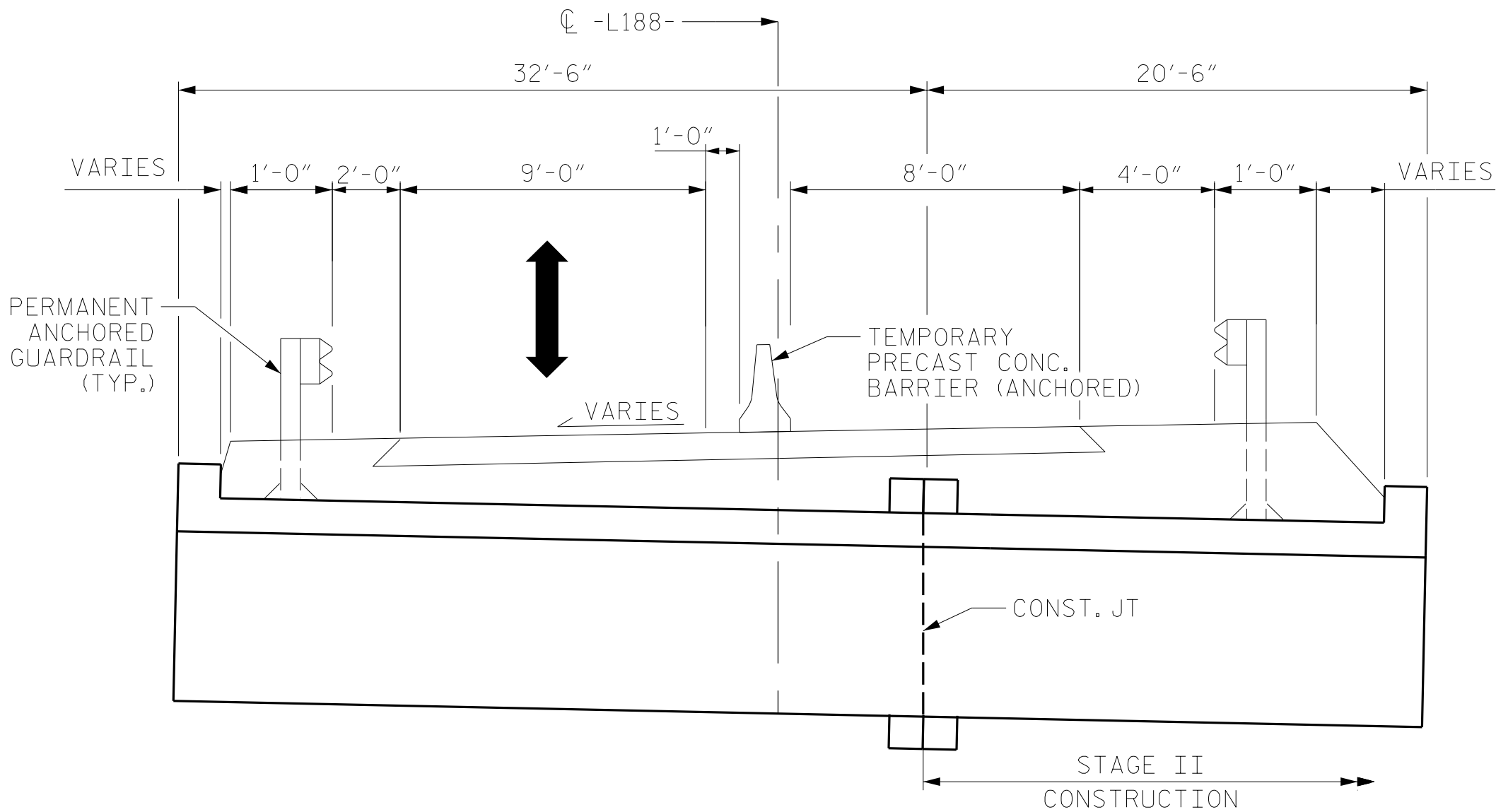

STAGE II CONSTRUCTION

NORMAL TO ROADWAY SECTION

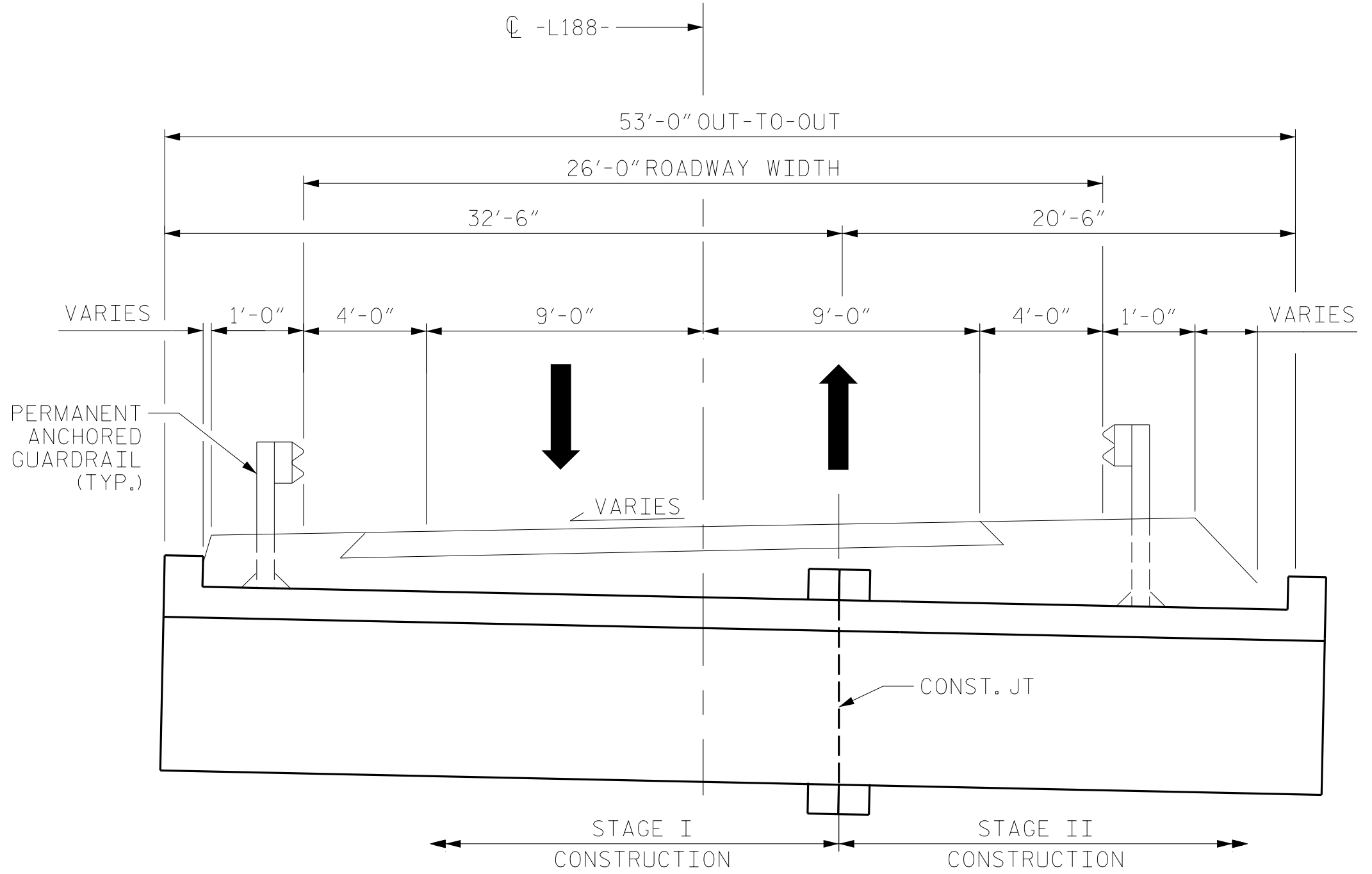

FINAL CONDITION

NORMAL TO ROADWAY SECTION

PROJECT NO. BP14.R002
HAYWOOD COUNTY
STATION: 12+82.90 -L188-

SHEET 3 OF 8

DRAWN BY : N. CUANY DATE : 03/2024
CHECKED BY : M. ACOSTA DATE : 03/2024
DESIGN ENGINEER OF RECORD: M. ACOSTA DATE : 08/2025

8/8/2025
\\rsandh.com\\files\\Transportation\\P\\1030014001.Div 14 Bridges.2016\\1030014001.R.173 430187.188.189.190\\Design\\Structures\\188\\CAD\\411.005-BP14.R002.SMU.CU.003-430188.dgn
AcostaM

NOTES:

TEMPORARY GUARDRAIL SHOWN FOR REFERENCE ONLY.

FOR GUARDRAIL OVER EXISITING STRUCTURE, SEE ROADWAY PLANS.

DOCUMENT NOT CONSIDERED
FINAL UNLESS ALL
SIGNATURES COMPLETED

STATE OF NORTH CAROLINA
DEPARTMENT OF TRANSPORTATION
RALEIGH

DOUBLE 8'-0" X 5'-0"
CONCRETE BOX CULVERT
STAGING DETAILS

135° SKEW

REVISIONS

NO.	BY:	DATE:	NO.	BY:	DATE:
1			3		
2			4		

RS&H Architects-Engineers-Planners, Inc.

8521 Six Forks Road, Suite 400
Raleigh, NC 27615
919-926-4100 FAX 919-846-9080
www.rsandh.com
North Carolina License Nos. 50073-F-0403-C-28

SHEET NO.
C2-3
TOTAL
SHEETS
8